

Lancaster County,  
Sadsbury  
Township

251-01-D  
Vacant Land  
pud 7

Ja<sup>s</sup> Leonard's  
Land

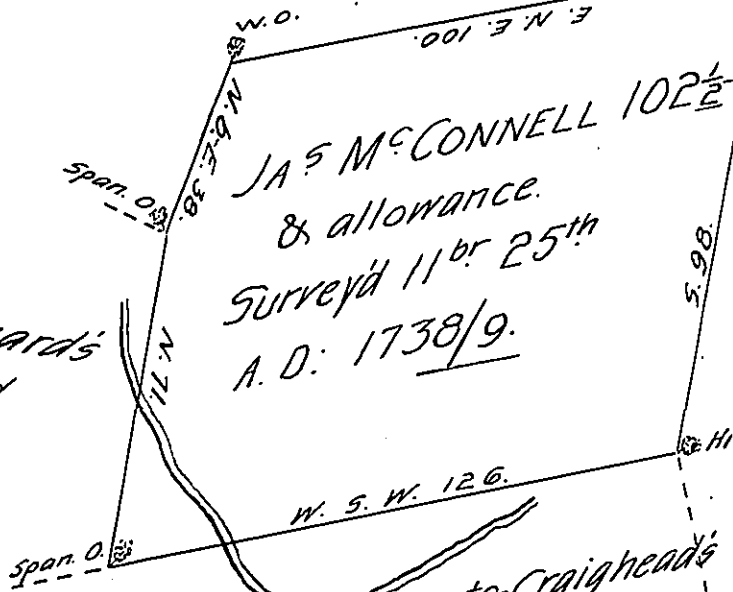

Ja<sup>s</sup> M<sup>c</sup>Connell's  
Land  
C-121-171-D  
Alex<sup>dr</sup>  
Craighead's  
Land

This tract of 102<sup>as</sup>  
is Return'd by Vertue of  
an order from y<sup>e</sup> Secretary  
Dated ffebruary 18<sup>th</sup> 1744.

J<sup>no</sup> Churchman--

Land Belonging to Craighead's  
Congregation  
C-224-86

98-722-D  
Craighead's Congregation's  
Land

George Leonard's Land

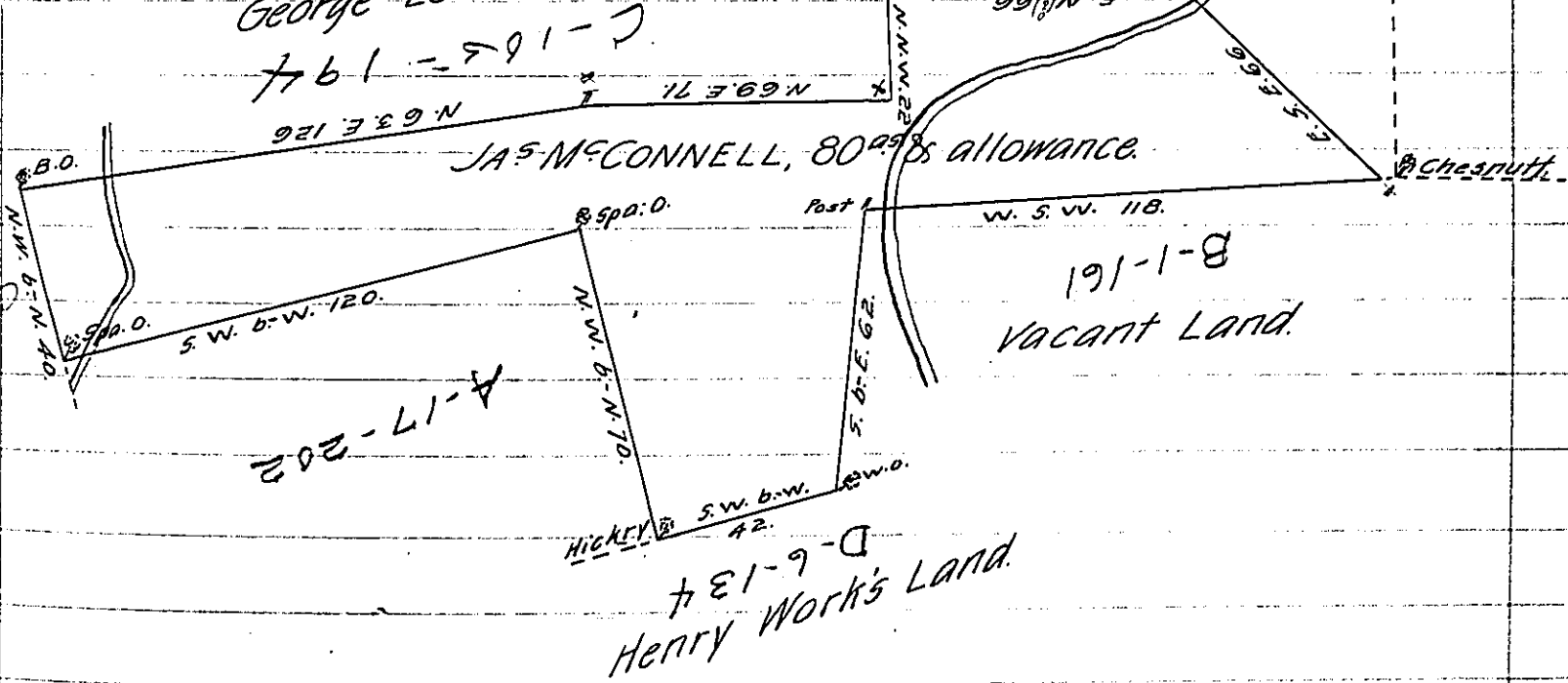

JA<sup>s</sup> M<sup>c</sup>CONNELL, 80<sup>as</sup> & allowance.

191-1-8  
Vacant Land

731-9-D  
Henry Work's Land

The above tract of 80<sup>as</sup> was survey'd for James M<sup>c</sup>Connell by Vertue of a War-  
rent Dated y<sup>e</sup> 6<sup>th</sup> Day of January A. D. 1737, on y<sup>e</sup> 11<sup>th</sup> Day of y<sup>e</sup> 11<sup>th</sup> Month A. D.  
1738/9.

J<sup>no</sup> Churchman.

IN TESTIMONY that the above is a copy of the original remaining on file in  
the Department of Internal Affairs of Pennsylvania, made  
conformably to an Act of Assembly approved the 16th day of  
February, 1833, I have hereunto set my Hand and caused  
the Seal of said Department to be affixed at Harrisburg,  
this third day of November 1905.

*[Signature]*  
Secretary of Internal Affairs.